

MATERIALS & HARDWARE

MATERIAL THICKNESS:

12mm [1/2"]

TOP LAYER COLOR:

ZINTRA TIMBER

BASE LAYER COLOR:

N/A

QUANTITY OF SHEETS USED:

DESIGN/PATTERN:

STICKS TRIM

HARDWARE:

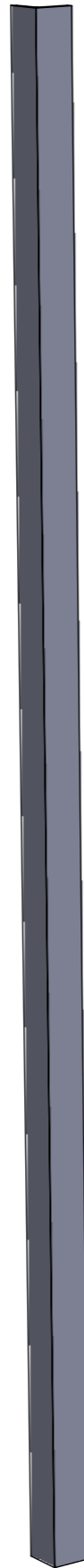

FRONT PERSPECTIVE



BACK PERSPECTIVE

P.O. NUMBER:

DATE: 28/01/2021

DESIGN:

CREATOR: TD

CLIENT APPROVAL

X _____
DATE:

REVISION

DATE	NUMBER

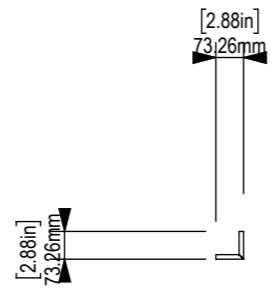

TOP VIEW

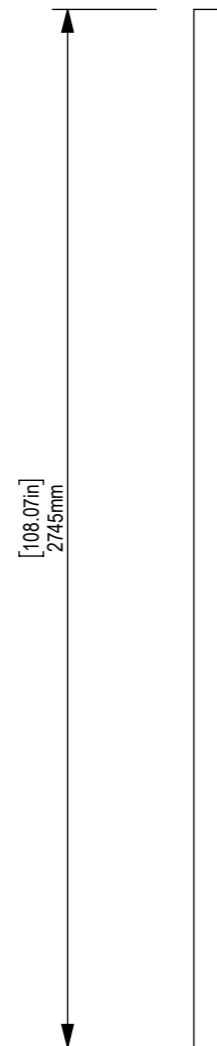

FRONT VIEW

GRAIN DIRECTION FOR ZINTRA TIMBER SPECIES

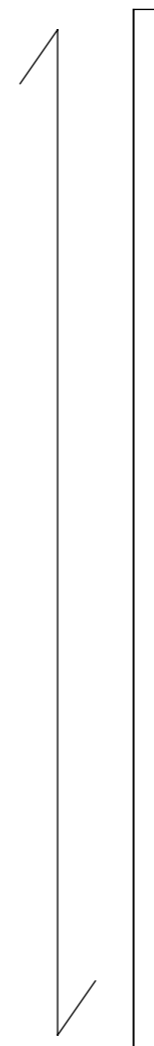

SIDE VIEW

P.O. NUMBER:
DATE: 28/01/2021
DESIGN:
CREATOR: TD

CLIENT APPROVAL

X _____
DATE:

REVISION

DATE	NUMBER